

WASTEWATER TREATMENT SOLUTIONS

WASTEWATER TREATMENT SOLUTIONS

Redco™ Plastic products are rust resistant, non-corrosive, and wear resistant; designed to protect and prolong equipment life.

Keep life-cycle costs and environmental impacts down by replacing metal pipes, concrete containers, scraper blades and sprockets with Redco™ Plastic products.



Redco™ UHMW Wear Shoes



WASTEWATER TREATMENT SOLUTIONS

APPLICATION MATERIAL GUIDE

Redco™ UHMW
SCREW CONVEYOR LINERS
WEARSTRIPS
78 SERIES SPROCKETS
720 SERIES SPROCKETS
SHAFT COLLARS
ROLLERS
SCRAPER BLADES
PULLEYS
HOPPER LINERS
CHUTE LINERS
BIN LINERS
WEAR SHOES

Redco™ NYLON
BUSHINGS
BEARINGS
720 SERIES SPROCKETS
PULLEYS

Redco™ WEARLON
CONTROL GATES

Redco™
POLYURETHANE
WEAR SHOES
SCRAPER BLADES
BUSHINGS
BEARINGS

WASTEWATER TREATMENT SOLUTIONS

Carrying and Return Wearshoes

Redco shoes are machined to meet industry standards for angle wearshoes. They can also be used to replace a complete knockout wearshoe system, resulting in weight reduction up to 15%. All angle wearshoes are reversible.

Redwood provides knock out wear shoes that are angled, flat or customized to your specifications. Standard shoes are available as well as custom fabricated shoes.

Electrolytic action experienced with metal to metal contact is eliminated with plastics shoes.

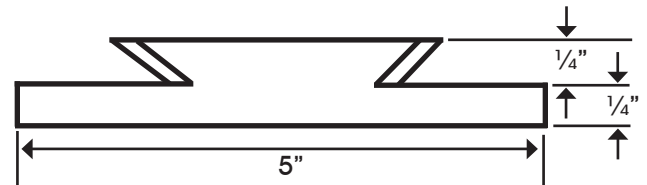
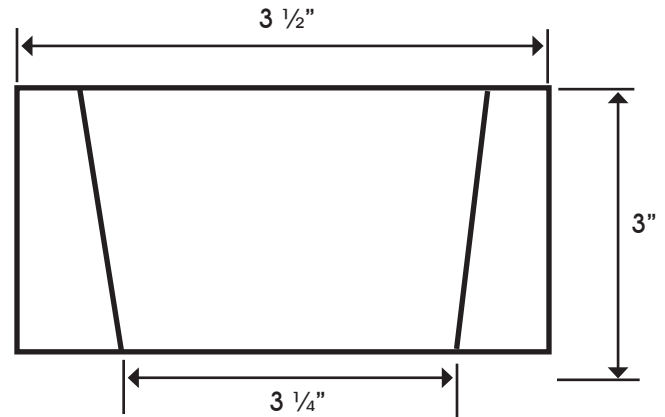

Knockout Wearshoe

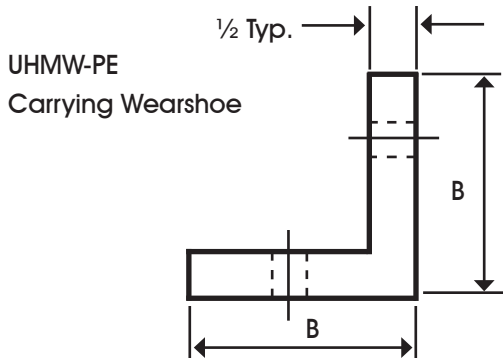
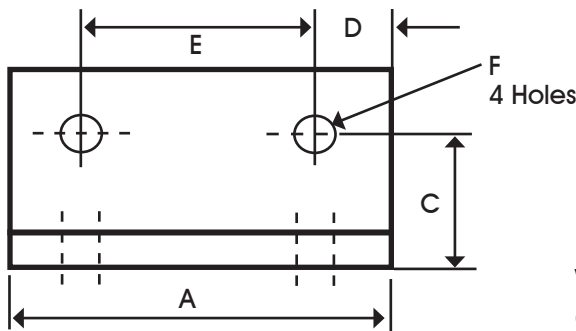

UHMW-PE
Carrying Wearshoe

Water Treatment Wearshoes Carrying Wearshoe (inches)

A	B	C	D	E	F
5 1/2	3	1 3/16	1/2	3/4	1/2
4 1/2	3	1 3/8	1/2	3/4	1/2
5 1/2	3	2 1/8	1/2	3/4	1/2
6	3	2 1/8	1/2	3/4	1/2

Custom Wearshoes can be made to your specifications.

Redco™ WASTEWATER TREATMENT WEARSHOES

Single Hole Return Wearshoe (inches)

A	B	C	D	E	F
4	3	3½	1 3/16	2	½
4	3	3½	2	1	½
4½	3	3½	2	1	½

Custom Wearshoes can be made to your specifications.

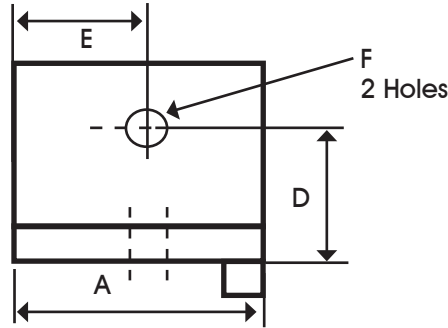

UHMW-PE Single Hole Return Wearshoe

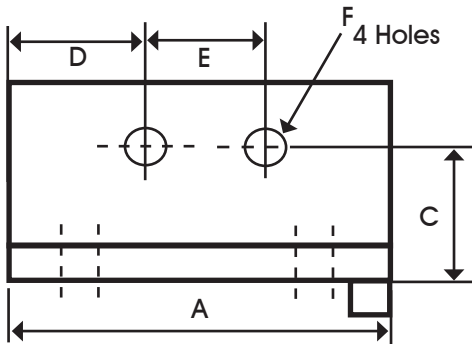
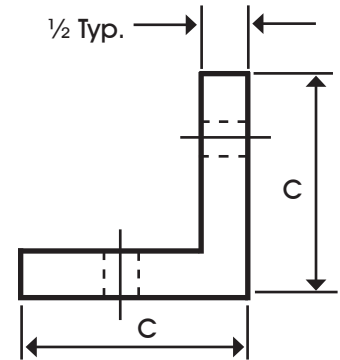

Double Hole Return Wearshoe (inches)

A	B	C	D	E	F
4½	3	3½	7/8	2¼	½
5½	3½	2	1½	2½	½

Custom Wearshoes can be made to your specifications.

UHMW-PE Double Hole Return Wearshoe

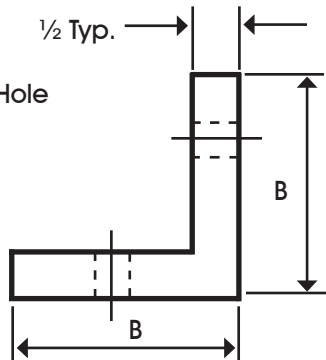

WASTEWATER TREATMENT SOLUTIONS

Chain Saver and Non-Chain Saver Sprockets

Eliminate Chain Wear

By eliminating the metal to metal contact between the chain barrel and sprocket tooth, your metal chain will last longer. Should there be misalignment of the sprockets, your chain side bar will be protected from wear.

Corrosion Resistant

Redco UHMW sprockets are resistant to sulfides, greases and chlorines to ensure long term part life and maintenance savings.

Excellent Wear Characteristics

Redco Sprockets are strong, resilient and flexible to withstand the severe torque and tension requirements of the various chain drive applications.

Redco Split Sprockets (inches)

Chain Pitch: 6.000

Roller Diameter: 1 3/8"

No. Teeth	Pitch Dia.	Outside Dia.	Bore (in.)		Hub	
			Stock	Max.	Dia.	LTB
13	12.89	13.39	1	3 7/8	7	3 27/32
17	16.59	17.09	1 3/4	4 1/2	8 7/8	3 27/32
19	18.45	18.95	1 3/4	4 1/2	8 7/8	3 27/32
21	20.33	20.83	1 3/4	4 1/2	8 7/8	3 27/32
23	22.21	22.71	1 3/4	4 1/2	8 7/8	3 27/32

Redco Split Sprockets (inches)

Chain Pitch: 6.000

Roller Diameter: 1 7/16"

No. Teeth	Pitch Dia.	Outside Dia.	Bore (in.)		Hub	
			Stock	Max.	Dia.	LTB
13	12.89	13.39	1	3 7/8	7	3 27/32
17	16.59	17.09	1 3/4	4 1/2	8 7/8	3 27/32
19	18.45	18.95	1 3/4	4 1/2	8 7/8	3 27/32
21	20.33	20.83	1 3/4	4 1/2	8 7/8	3 27/32
23	22.21	22.71	1 3/4	4 1/2	8 7/8	3 27/32

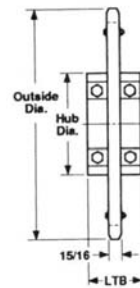
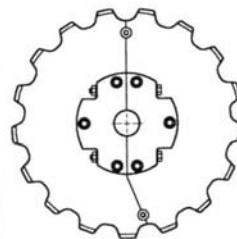

Redco™ WASTEWATER TREATMENT SPROCKETS

Redco Split Chain Saver Sprockets (inches)

Chain Pitch: 6.000

Roller Diameter: 1 7/16"

No. Teeth	Pitch Dia.	Outside Dia.	Chain Saver Hub Dia.	Bore (in.)		Hub	
				Stock	Max.	Dia.	LTB
13	12.89	13.39	10.03	1	3 7/8	7	3 27/32
17	16.59	17.09	14.07	1 3/4	4 1/2	8 7/8	3 27/32
19	18.45	18.95	16.06	1 3/4	4 1/2	8 7/8	3 27/32
21	20.33	20.83	18.04	1 3/4	4 1/2	8 7/8	3 27/32
23	22.21	22.71	20.00	1 3/4	4 1/2	8 7/8	3 27/32

Specify bore size when ordering.

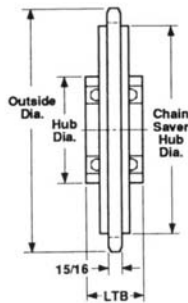
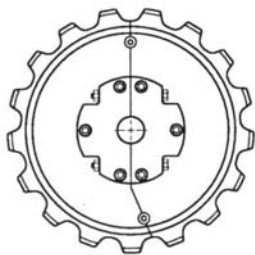

WASTE WATER TREATMENT SOLUTIONS

Segmental Sprockets

Redco™ water treatment segmental sprockets are divided into three sections for easy replacement. These sprockets are manufactured to fit your specific hub configurations. Segmental sprockets are available for other chain types upon request.

Applications

- Rectangular clarifiers
- Cross & grit collectors
- Chlorine contact tanks
- Aerator tanks
- Bar & water screens

Benefits

- Eliminates chain wear
- Corrosion resistant
- Excellent wear characteristics
- Quick and easy change

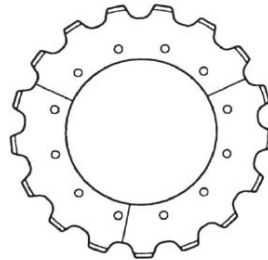

Standard Segmental Water Treatment Sprocket

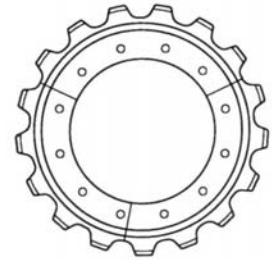

Chain Saver Segmental Water Treatment Sprocket

Shaft Collars

Redco™ UHMW shaft collars have high corrosion resistance and also exhibit high strength at considerably less cost than stainless steel or other metals. Water treatment shaft collars are manufactured from Redco™ UHMW.

Benefits

- Corrosion resistant
- Abrasion resistant
- Chemical resistant
- Self-lubricating
- Strong
- Moisture resistant

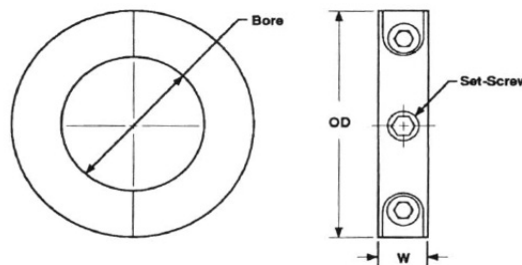

W	OD	Bore (in.)	
		Stock	Max.
1	6.00	1	4
1	8.00	1 ½	5

Redco™ WASTEWATER TREATMENT WEARSTRIPS

Wearstrip

Redco UHMW Wearstrips offer superior protection for rails and other moving machinery. UHMW-PE wearstrip is easy to install, weighing about 1/8 that of steel. It can also outwear abrasion resistant steels 6 to 1 and can reduce noise levels up to 50%. Redco Black UHMW has good dielectric properties and will not absorb water and swell.

Available in various thicknesses and widths in 120" lengths.

BENEFITS

- Eliminates wear on the bottom and side rails
- Corrosion resistant
- Flights run smoothly without surging
- Light weight
- Easy to install

APPLICATIONS

- Flights of rectangular clarifiers
- Flights for cross collectors

Common Wearstrip Configurations

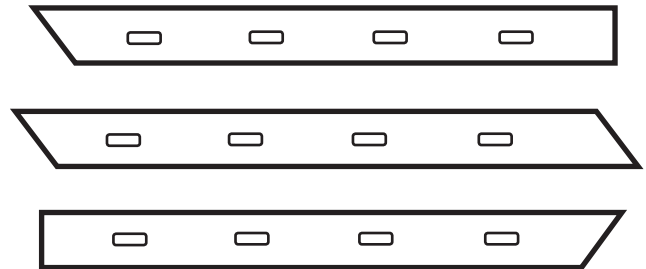

LINERS

Redco™ Liners and Lining Systems protect equipment from corrosion, wear, erosion, and heat.

Materials are also available to absorb impact and prevent leaking to save downtime and prevent costly damage to equipment.



Redco™ UHMW
Screw Conveyor Liner